

ACEWELL

Twin-Wall Polycarbonate

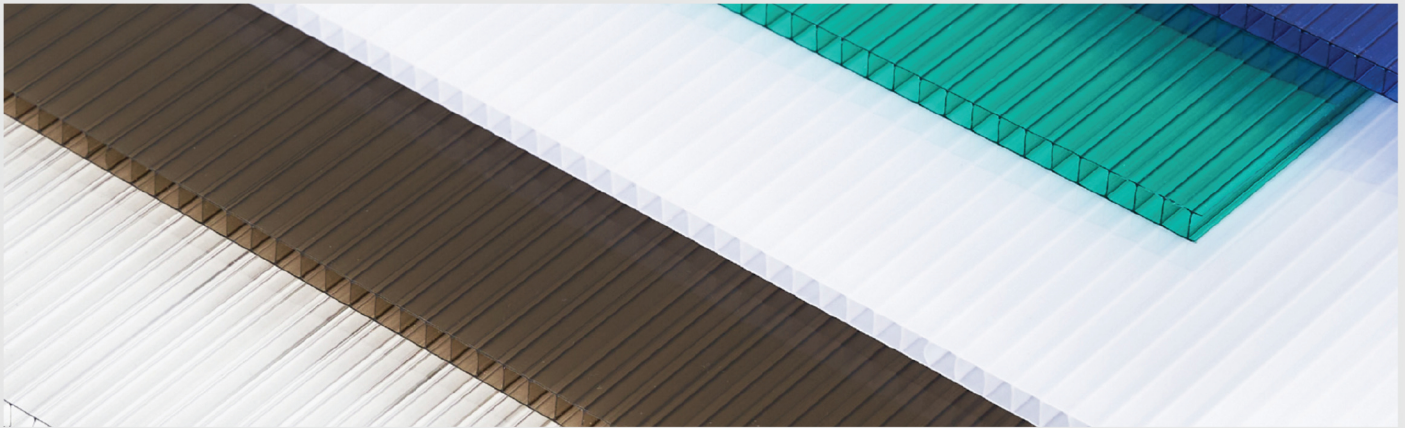

Variations

Thickness (mm)	Dimensions (ft x ft)	Type
4.0	4 x 2, 4 x 8, 4 x 12, 4 x 19, 7 x 19	Panel
6.0	4 x 2, 4 x 8, 4 x 10, 4 x 12, 4 x 16, 4 x 19, 4 x 20, 4 x 28, 7 x 16, 7 x 19, 7 x 20	
8.0	4 x 8, 4 x 16, 7 x 19	
10.0	4 x 8, 4 x 12, 4 x 16, 4 x 19, 4 x 20, 7 x 16, 7 x 19, 7 x 20	

Colors: Bronze, Clear, Blue, Green, White, Blue Green, Gray, Red, Yellow, Orange, Frosted

Lightweight
Only half the density of glass, which could save delivery and installation cost.

Impact Strength
Greater impact strength compared to annealed glass.

High Clarity
Up to 84% luminous transmission.

Flame Retardancy
Self-extinguishing; does not amplify flames or give off toxic gases and has a B1 GB 8624-2012 rating.

Thermal Stability
Minimal property changes within the temperature range of -40°C to 120°C.

Weatherability
Co-extruded UV layer enables long-term UV radiation protection.

Heat Insulation
Good thermal insulation performance, minimizing heat consumption.

Formability
Ease of fabrication; a huge range of shapes and sizes can be formed.

Installation Guide

Twin-wall Polycarbonate Installation using Aluminum Flatbar on Edges

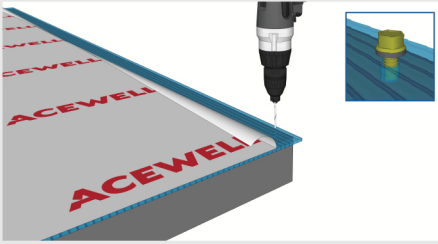

Step 1
Peel the protective cover along the edges and predrill holes 50% larger than its diameter size.

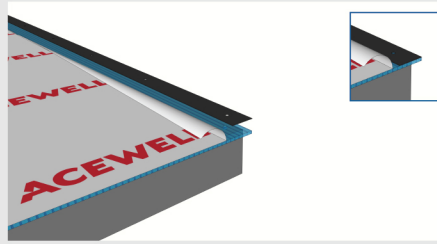

Step 2
Stick the rubber tape along the edge.

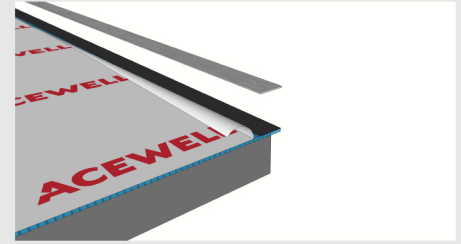

Step 3
Place the aluminium flat bar on top of the rubber tape.

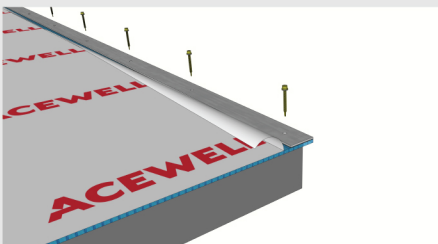

Step 4
Secure the aluminium flat bar onto the frame using tekscrews. Be careful not to overtighten.

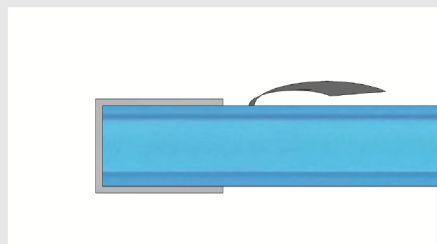

Step 5
Peel the protective cover along the front edge of the panel and affix the aluminum U-clip against the edge to cover the hollow area.

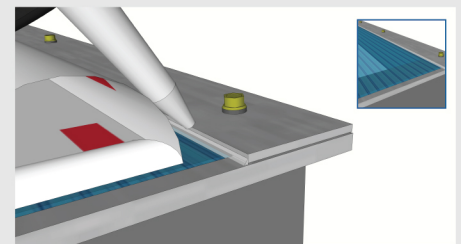

Step 6
Apply sealant along the sides of the flatbar and completely remove the protective cover.

Twin-wall Polycarbonate Installation using Aluminum Flatbar in between Panels

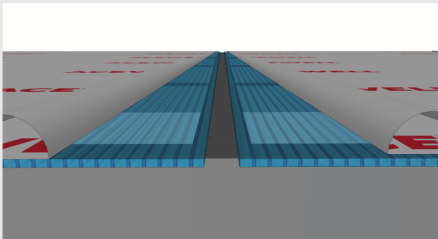

Step 7
Peel a portion of the protective film along the panel edges. Leave a space gap of up to 3/4 inch between sheets for thermal expansion.

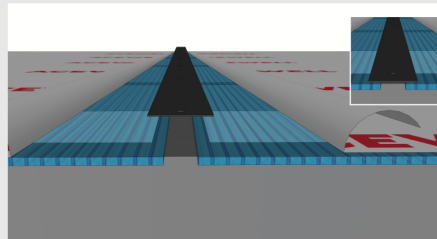

Step 8
Stick the rubber tape evenly between the panels.

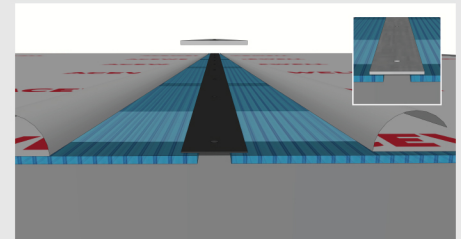

Step 9
Place the aluminium flatbar on top of the rubber tape.

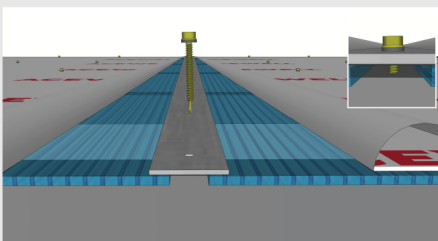

Step 10
Secure the aluminium flat bar onto the frame using tekscrews. To prevent damage due to thermal expansion, make sure that the tekscrew is not touching the polycarbonate.

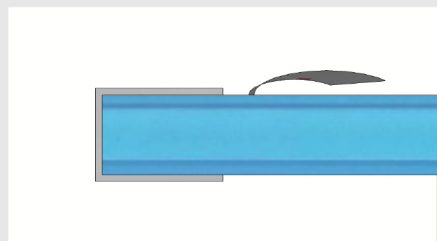

Step 11
Peel the protective cover along the edge of the panel and affix the aluminum U-clip against the edge to cover the hollow area.

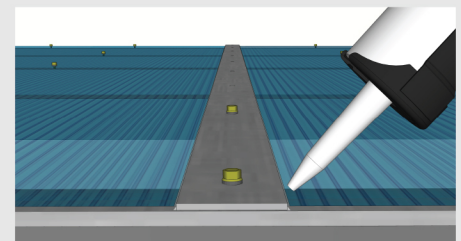

Step 12
Apply sealant along the sides of the flatbar and remove the rest of the protective cover.

Technical Data

Test Item	Test Method	Test Condition	Result
Density	ASTM D792-13 Method B	Absolute Alcohol 23 ± 0.5 °C	1.20g/cm ³
Total Luminous transmittance	ASTM D1003-13 Procedure A	Specimen thickness 6.17 mm; light source C; Beam diameter 6.95 mm	83.7%
Haze			29.1%
Impact Resistance	ASTM D5420-16	Specimen thickness: 6.14mm (Maximum thickness); Geometry: GE; Strike weight: 3.6kg	Mean Failure Energy: 10.9 J
Coefficient of linear thermal expansion	ASTM E831-19	Specimen - X direction: 9.97mmx5.42mmx2.93mm Specimen - Y direction: 9.96mmx5.44mmx2.91 mm Rate of temperature: 5°C/min; Load: 50mN; Flow rate(N ₂): 50ml/min; Test temperature: 20°C-80°C; Test direction: X direction & Y direction	X direction: 76.6 um/(m·°C)
			Y direction: 76.4 um/(m·°C)

Disclaimer Notice: This information is given in good faith and to the best of our knowledge, but without any warranty. Users of our materials should determine the suitability for a specific application. It is always advisable to do preliminary testing.

ACEWELL

PolyLite.com.ph