



Variations

Profiles

SPC Flooring (10pcs./box)

Dimensions

1220mm x 183mm x 5mm

Colors

Oak, Walnut, Narra, Light Cedar, Ocean Grey, Sonors

Accessories : Stairnose, Skirting, T-Moulding (with U-track), End cap (with U track)

About Decolite's SPC Flooring

Decolite's Stone Plastic Composite (SPC) flooring is a durable and aesthetic solution for your flooring needs. The material is composed of limestone, polyvinyl chloride, and plasticizers, which makes it rigid and suitable for foot traffic and even furniture. It has a variety of finishes that resembles wood, suitable for both residential and commercial settings. This comes in a box of 10 pcs and features a click-lock system for easy flooring installation.

Preliminary Considerations

Material

Inspect the material under good lighting for possible damages (production flaw, incorrect color or shade, etc.) upon receipt to be reported immediately. Once installed, damaged materials won't be replaced.

Some variations in color and structure as a result of the material's natural properties cannot be the subject of a claim.

SPC Flooring can be susceptible to possible alterations in color and dimensions due to exposure to external conditions (sunlight, chemical pollutants, high temperature, and humidity levels). Expect a slight change between 0.15% and 0.30% dilatation.

The warranty will not cover damage brought by improper usage of the product.

Preliminary Considerations

Storage

Always store your SPC flooring horizontally, avoiding an upright position.

To prevent excessive dilation due to extreme high or low temperatures, it is crucial to ensure covering or shading during storage and keep boxes unopened until ready for installation.

Once ready to install, open the boxes at the ends and acclimate the product by allowing it to reach the room temperature for at least 24 hours.

Project Site Condition

Before installing the SPC flooring, the project site and subfloor must abide to the following standard conditions:

Product application for outdoor use, sunrooms, showers, or rooms with constant water exposure is not recommended.

Avoid installing in areas that are not temperature controlled. The recommended conditions include an optimal temperature range of 20°C/22°C and humidity levels between 50–60%.

Ensure that the subfloor is compact and sturdy, clean from debris, and level with a maximum deviation of 2mm per meter. In case of uneven areas, use of a self-leveling base combined with a prior primer is advisable.

Consider using expansion joints under doors, in lengthy hallways, or on surfaces that are longer than 12 m or wider than 10 m for 120 m².

Trim the door frames to allow the flooring to move freely without any pinching.

SPC Flooring Installation

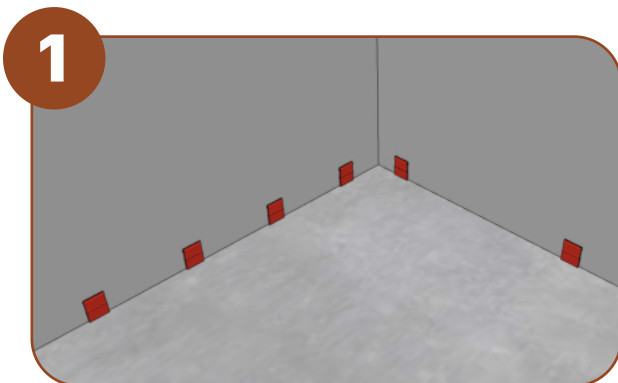

Place spacers along the subfloor perimeter, creating a 10 mm gap between the corners and the flooring to allow for product expansion.

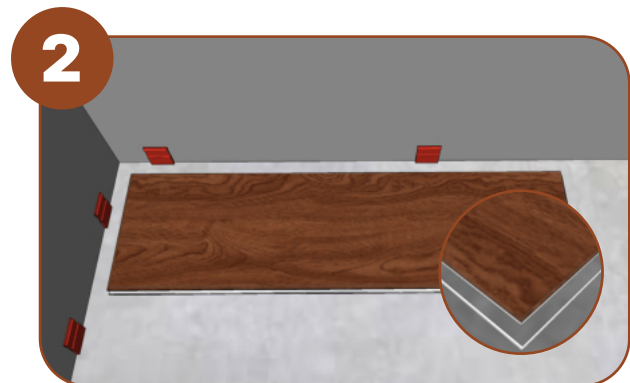

Begin laying the first row from left to right, making necessary cut to the sides that is facing the wall.

SPC Flooring Installation

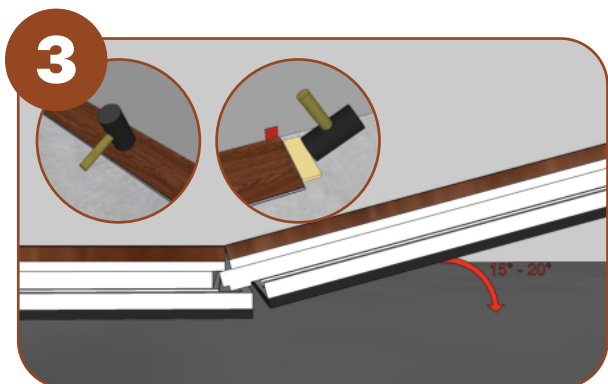

Install the next lateral panel by engaging its tongue side to the groove side of the initial panel at a 15-20° angle, then drop it until the click of closing is heard. If any gaps are visible, use a tapping block and a rubber mallet to ensure a snug fit.

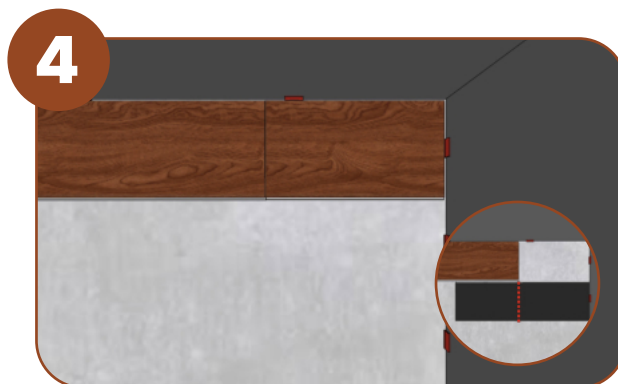

Upon reaching the final board, cut it to the required length to complete the first row.



Use the remaining portion of the previous panel as the starting piece for the second row, gently inserting its tongue side into the groove side of the already installed panels. It is recommended to stagger the short end joints by a minimum of 300mm.

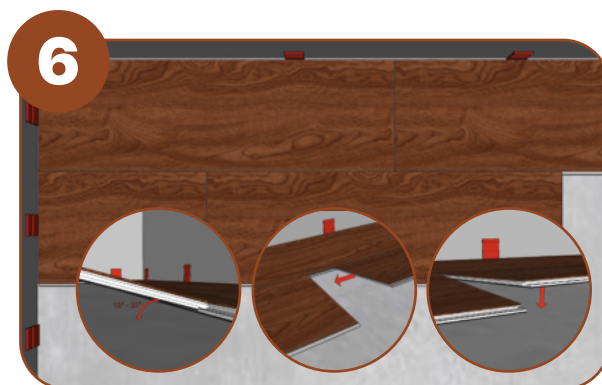

Proceed with the installation of the succeeding panel by first aligning its long edge at a 15-20° angle with the already installed panels. Slide it toward the end of the previously installed panel until the tongue touches the groove then click in.

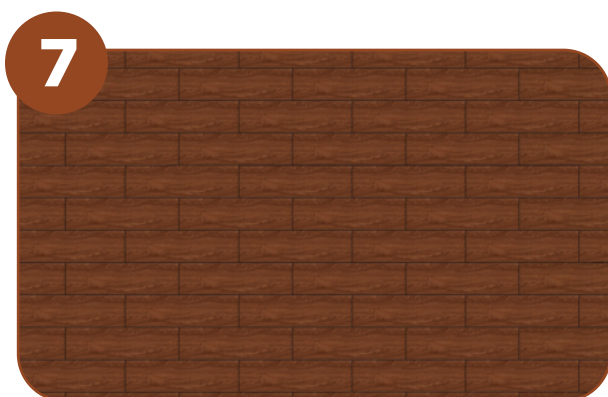

Continue with the procedure by clicking each panel into the previous one and cutting necessary lengths to fill in until you reach the end of the subfloor. Use a tapping block and a hammer to ensure a secured and aligned joining.

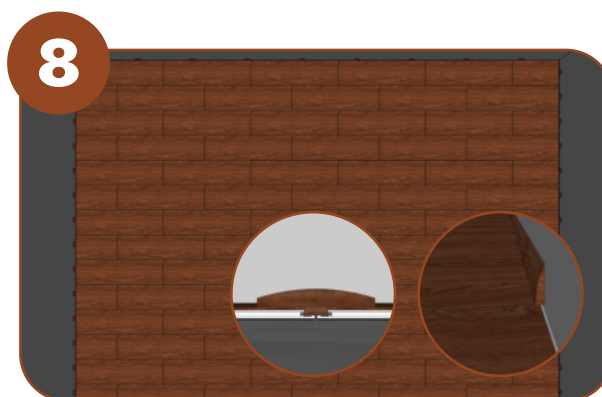

After installing all flooring, remove the spacers, and complete the finished look by installing trim or cap along the edges.

Maintenance and Care

Maintenance

Maintain ambient conditions even after installation.

Protect the flooring by putting felt pads beneath the tables, chairs, and other furniture. As required by the standards, office chairs must have soft polyamide wheels.

Avoid setting up heavy furniture on the floor because it may block the flooring's normal movements.

To move heavy pieces of furniture, lift them up instead of pushing them.

Cleaning

For daily cleaning, use intensive cleaning that is never wet but moist and well squeezed.

Use only appropriate products, and adhere to our recommendations.

Glycerin shouldn't be used with aggressive essences because they could damage the surface.

Technical Data

Component	Layers	
Limestone (CaCO ₃)	UV Layer	Bottom Layer
PVC	PVC Wear Layer	Anti-synovial layer
Stabilizers	Print Film	
Additional Components	Glass Fiber Mesh	

Characteristic

Material Characteristics	Requirements	Results
VOC Regulation	TVOCtol class: A+: <1000 A: <1500 B: <2000 C: >2000	29 (class A+)
CMR Regulation	After 28 days [ug/cu.m]: Benzene: <1 Trichlorethylene: <1 Bis(2-ethylhexyl) phthalate (DEHP): <1 Dibutyl phthalate (DBP): <1	After 28 days [ug/cu.m]: Benzene: <1 Trichlorethylene: <1 Bis(2-ethylhexyl) phthalate (DEHP): <1 Dibutyl phthalate (DBP): <1
Reaction to Fire	EN 13501-1	Class Bfl
Slipperiness	EN 13893	Class DS
Certifications		Green Guard
		FloorScore